

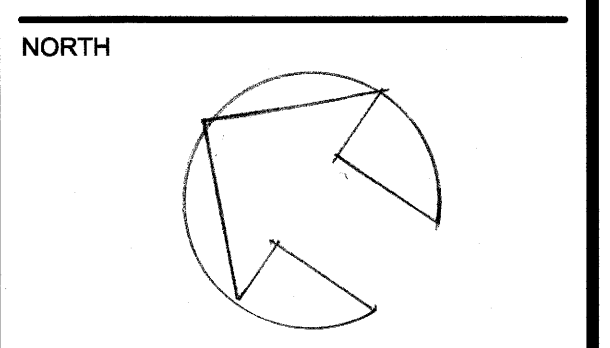



- NOTES**
- This plan and design are the exclusive property of VAN DE POLL GARDEN DESIGN and may not be used or reproduced without written consent.
  - Written dimensions shall take precedence over scaled dimensions.
  - Contractor shall verify and be responsible for all dimensions and conditions on the site. VAN DE POLL GARDEN DESIGN shall be informed of any variations from the dimensions and the conditions shown on the drawing.
  - It is the Contractor's responsibility to perform the work as detailed in the contract documents/drawings. Therefore, it is necessary for the Contractor to accurately review the actual site dimensions, elevations and the conditions which may vary from those assumed on the drawings.
  - Any discrepancies which the Contractor(s) discovers within the contract documents/drawings themselves or between the contract documents/drawings and the site conditions are to be discussed with VAN DE POLL GARDEN DESIGN immediately before proceeding with any work.
  - All work shall conform to the current Standards of the BC Landscape Nursery Association/BC Society of Landscape Architects, local Building Codes and Local Bylaws.
  - The Owner or the Contractor shall be responsible for the correct siting of the home on the property.



**REVISIONS**

**PROJECT**  
MUKER  
RESIDENCE  
4701 SOUTH PICCADILLY RD.  
WEST VANCOUVER, BC

**DRAWING TITLE**  
PLANTING PLAN  
OF  
SEPARATE DRIVEWAY  
LAYOUT

PROJECT NO. MU-15	DATE JULY 2016
DRAWING NO. 2B	SCALE 1/8" = 1'0"
	DRAWN BY RV

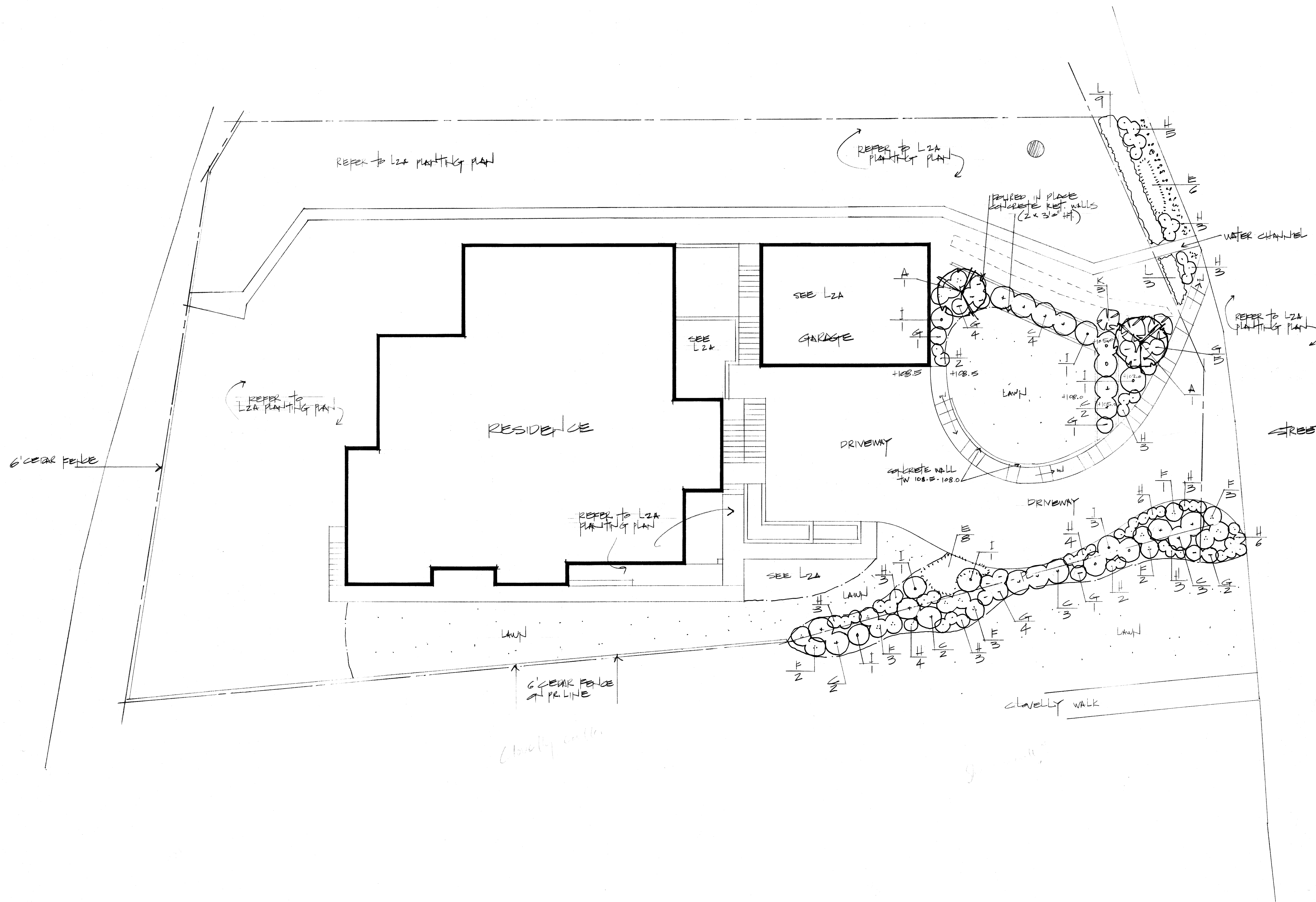

# planting plan: muker residence (separate driveway layout)

**EXPOSURE (EXP.):**

S-sun  
Sh-shade  
PSh-part shade

**TYPE:**

B-biennial  
C-coniferous  
D-deciduous  
E-evergreen  
V-vine  
Gr-ornamental grass  
P-perennial  
S-shrub  
T-tree  
G-ground cover

**SIZE:**

gal=gallon pot si  
cal=trunk caliper size  
ht=height  
SPACING:  
oc=on center

-SUPPLY AND INSTALLATION OF PLANTS SHALL CONFORM TO B.C.L.N.A. & B.C.S.L.A. STANDARDS

-PLANT SUBSTITUTIONS SHALL BE APPROVED BY VAN DE POLL GARDEN DESIGN

KEY	BOTANICAL NAME	COMMON NAME / REMARKS	QNTY	SIZE	SPACING	TYPE	EXP.
A	Acer palmatum 'Sangokaku'	<i>Coral Bark Maple</i> / bright cream-grn lobed lvs, pinkish bark	2	7' ht	per plan	DT	S,Sh
B	Buxus microphylla 'Winter Gem'	<i>Boxwood</i> / soft green growth, dense compact, hedging habit			12-18"oc	ES	S, PSh
C	Choisya ternata	<i>Mexican Orange Blossom</i> / white scented flws-May, glossy lvs	22	3 gal	3'6"oc	ES	S,Sh PSh
D	Cornus kousa 'Milky Way'	<i>Chinese Dogwood</i> / large creamy June flws, fall colour, multi-stemmed	2	12' ht.	per plan	DT	S, PSh
E	Erica carnea 'Springwood White'	<i>Winter Heath</i> / white bell shaped flw clusters-Dec	21	1 gal	18-24"oc	ES	S, PSh
F	Euphorbia characias wulfenii	<i>Evergreen Spurge</i> / grn-yellow flw clusters-early spring, leathery lvs	32	1 gal	2'6"oc	ES,P	S, PSh
G	Hakonechloa macra 'Aureola'	<i>Japanese Forest Grass</i> / bright golden-yellow lvs with grn stripes,weeping form	26	1 gal	18-24"oc	Gr	PSh
H	Helictotrichon sempervirens	<i>Blue Oat Grass</i> / blue grass lvs, tan flws, May-July, dome form	77	1 gal	18-24"oc	Gr	S
I	Hydrangea macrophylla 'Lanarth White'	<i>Lacecap Hydrangea</i> / flw clusters of small white lacecaps-summer	12	3 gal	3'0"oc	DS	S,Sh
J	Pachysandra terminalis	<i>Japanese Spurge</i> / white flws-spring, low mat of glossy grn lobed lvs	195	4" pot	12-18"oc	EG	Sh
K	Polystichum munitum	<i>Western Sword Fern</i> / shiny dark grn large leathery fronds	103	1 gal	2'6"oc	ES	Sh, PSh
L	Thuja plicata excelsa	<i>Red Cedar</i> / deep green glossy scale-like lvs	46	8' ht.	3'0"oc	CST	S, PSh
M	Skimmia japonica	<i>Skimmia</i> / leathery lvs, fragrant tiny white flws-spring, red fall fruit	18	3 gal	4'0"oc	ES	Sh, PSh
N	Thuja occidentalis 'Brandon'	<i>Pyramidal Cedar</i> / dense narrow form, bright green scaly lvs	3	10' ht.	per plan	CST	S, PSh
O	Picea omorika	<i>Serbian Spruce</i> / narrow columnar form, sweeping branches, dark green	1	8' ht.	per plan	CT	S, PSh