

AREAS BOUNDED BY HEAVY LINES AS PER LEGEND HAVE NOT BEEN KEPT UP AS TASK FORCE ENVISIONED - REGULAR ACTION IS REQUIRED.

TAKE ACTION TO PREVENT THE DISCHARGE OF WATER ON PARK PROPERTY AT THE EAST SIDE OF 4648 WHICH IS DAMAGING ACCESS STAIRS.

PURSUIT OF THIS IDEA TO BE UNDERTAKEN BY STAFF VIA THE 1996 BUDGET PROCESS.

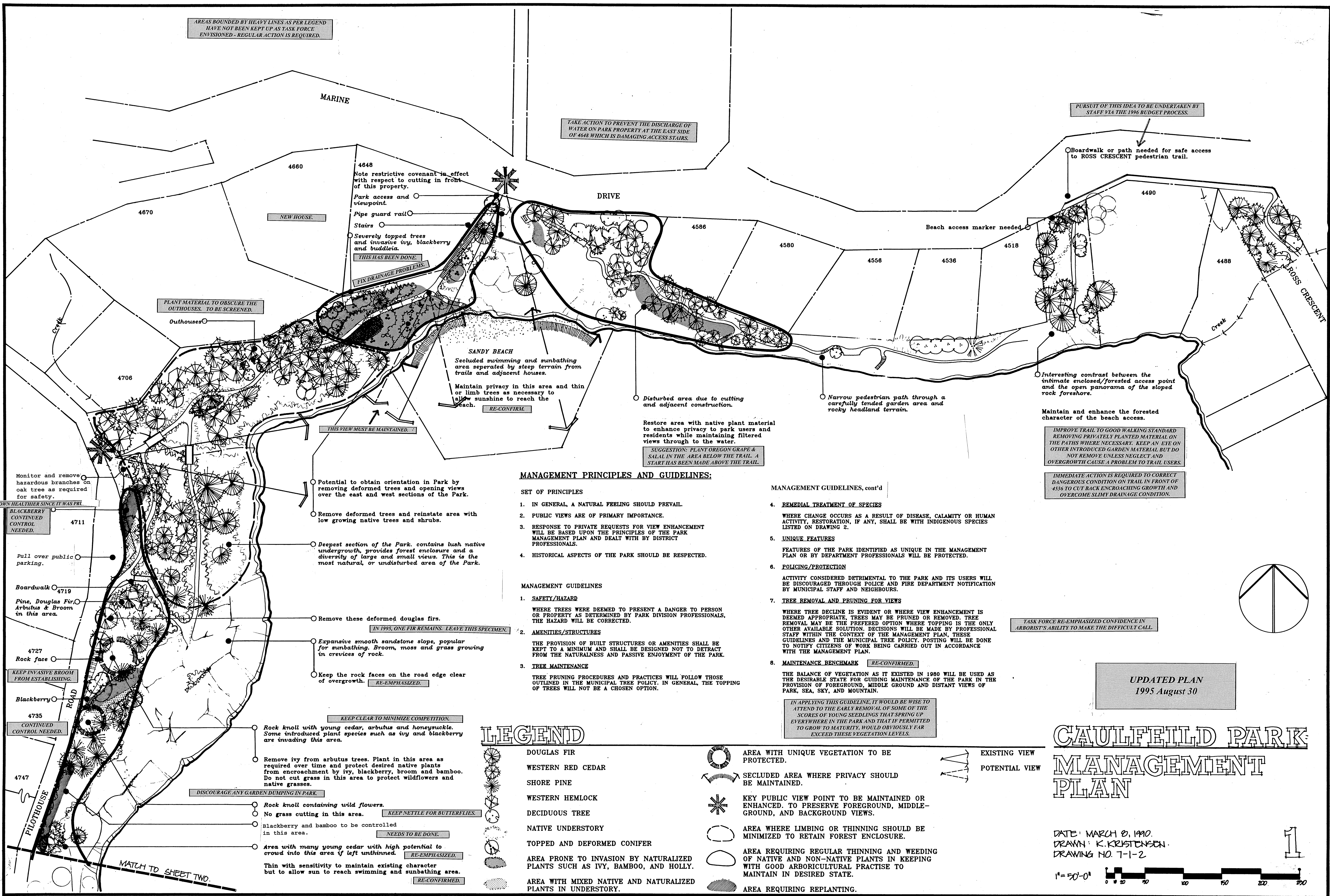

**MANAGEMENT PRINCIPLES AND GUIDELINES:**

**SET OF PRINCIPLES**

1. IN GENERAL, A NATURAL FEELING SHOULD PREVAIL.
2. PUBLIC VIEWS ARE OF PRIMARY IMPORTANCE.
3. RESPONSE TO PRIVATE REQUESTS FOR VIEW ENHANCEMENT WILL BE BASED UPON THE PRINCIPLES OF THE PARK MANAGEMENT PLAN AND DEALT WITH BY DISTRICT PROFESSIONALS.
4. HISTORICAL ASPECTS OF THE PARK SHOULD BE RESPECTED.

**MANAGEMENT GUIDELINES**

1. **SAFETY/HAZARD**  
WHERE TREES WERE DEEMED TO PRESENT A DANGER TO PERSON OR PROPERTY AS DETERMINED BY PARK DIVISION PROFESSIONALS, THE HAZARD WILL BE CORRECTED.
2. **AMENITIES/STRUCTURES**  
THE PROVISION OF BUILT STRUCTURES OR AMENITIES SHALL BE KEPT TO A MINIMUM AND SHALL BE DESIGNED NOT TO DETRACT FROM THE NATURALNESS AND PASSIVE ENJOYMENT OF THE PARK.
3. **TREE MAINTENANCE**  
TREE PRUNING PROCEDURES AND PRACTICES WILL FOLLOW THOSE OUTLINED IN THE MUNICIPAL TREE POLICY. IN GENERAL, THE TOPPING OF TREES WILL NOT BE A CHOSEN OPTION.

**MANAGEMENT GUIDELINES, cont'd**

4. **REMEDIAL TREATMENT OF SPECIES**  
WHERE CHANGE OCCURS AS A RESULT OF DISEASE, CALAMITY OR HUMAN ACTIVITY, RESTORATION, IF ANY, SHALL BE WITH INDIGENOUS SPECIES LISTED ON DRAWING 2.
5. **UNIQUE FEATURES**  
FEATURES OF THE PARK IDENTIFIED AS UNIQUE IN THE MANAGEMENT PLAN OR BY DEPARTMENT PROFESSIONALS WILL BE PROTECTED.
6. **POLICING/PROTECTION**  
ACTIVITY CONSIDERED DETRIMENTAL TO THE PARK AND ITS USERS WILL BE DISCOURAGED THROUGH POLICE AND FIRE DEPARTMENT NOTIFICATION BY MUNICIPAL STAFF AND NEIGHBOURS.
7. **TREE REMOVAL AND PRUNING FOR VIEWS**  
WHERE TREE DECLINE IS EVIDENT OR WHERE VIEW ENHANCEMENT IS DEEMED APPROPRIATE, TREES MAY BE PRUNED OR REMOVED. TREE REMOVAL MAY BE THE PREFERRED OPTION WHERE TOPPING IS THE ONLY OTHER AVAILABLE SOLUTION. DECISIONS WILL BE MADE BY PROFESSIONAL STAFF WITHIN THE CONTEXT OF THE MANAGEMENT PLAN, THESE GUIDELINES AND THE MUNICIPAL TREE POLICY. POSTING WILL BE DONE TO NOTIFY CITIZENS OF WORK BEING CARRIED OUT IN ACCORDANCE WITH THE MANAGEMENT PLAN.
8. **MAINTENANCE BENCHMARK** *RE-CONFIRMED.*  
THE BALANCE OF VEGETATION AS IT EXISTED IN 1980 WILL BE USED AS THE DESIRABLE STATE FOR GUIDING MAINTENANCE OF THE PARK IN THE PROVISION OF FOREGROUND, MIDDLE GROUND AND DISTANT VIEWS OF PARK, SEA, SKY, AND MOUNTAIN.

IN APPLYING THIS GUIDELINE, IT WOULD BE WISE TO ATTEND TO THE EARLY REMOVAL OF SOME OF THE SCORES OF YOUNG SEEDLINGS THAT SPRING UP EVERYWHERE IN THE PARK AND THAT IF PERMITTED TO GROW TO MATURITY, WOULD OBVIOUSLY FAR EXCEED THESE VEGETATION LEVELS.

IMPROVE TRAIL TO GOOD WALKING STANDARD REMOVING PRIVATELY PLANTED MATERIAL ON THE PATHS WHERE NECESSARY. KEEP AN EYE ON OTHER INTRODUCED GARDEN MATERIAL BUT DO NOT REMOVE UNLESS NEGLECT AND OVERGROWTH CAUSE A PROBLEM TO TRAIL USERS.

IMMEDIATE ACTION IS REQUIRED TO CORRECT DANGEROUS CONDITION ON TRAIL IN FRONT OF 4536 TO CUT BACK ENCROACHING GROWTH AND OVERCOME SLIMY DRAINAGE CONDITION.

TASK FORCE RE-EMPHASIZED CONFIDENCE IN ARBORIST'S ABILITY TO MAKE THE DIFFICULT CALL.

**UPDATED PLAN**  
1995 August 30

**LEGEND**

- DOUGLAS FIR
- WESTERN RED CEDAR
- SHORE PINE
- WESTERN HEMLOCK
- DECIDUOUS TREE
- NATIVE UNDERSTORY
- TOPPED AND DEFORMED CONIFER
- AREA PRONE TO INVASION BY NATURALIZED PLANTS SUCH AS IVY, BAMBOO, AND HOLLY.
- AREA WITH MIXED NATIVE AND NATURALIZED PLANTS IN UNDERSTORY.
- AREA WITH UNIQUE VEGETATION TO BE PROTECTED.
- SECLUDED AREA WHERE PRIVACY SHOULD BE MAINTAINED.
- KEY PUBLIC VIEW POINT TO BE MAINTAINED OR ENHANCED. TO PRESERVE FOREGROUND, MIDDLE-GROUND, AND BACKGROUND VIEWS.
- AREA WHERE LIMBING OR THINNING SHOULD BE MINIMIZED TO RETAIN FOREST ENCLOSURE.
- AREA REQUIRING REGULAR THINNING AND WEEDING OF NATIVE AND NON-NATIVE PLANTS IN KEEPING WITH GOOD ARBORICULTURAL PRACTISE TO MAINTAIN IN DESIRED STATE.
- AREA REQUIRING REPLANTING.
- EXISTING VIEW
- POTENTIAL VIEW

**CAULFEILD PARK**  
**MANAGEMENT**  
**PLAN**

DATE: MARCH 8, 1990.  
DRAWN: K. KRISTENSEN.  
DRAWING NO. 7-1-2

